

VERMEIREN

Eclips XXL

INSTRUCTION MANUAL





Instructions to the specialist dealer

This instruction manual is part and parcel of the product and must accompany every product sold.

Version: C, 2013-04

All rights reserved, including translation.

No part of this manual may be reproduced in any form what so ever (print, photocopy, microfilm or any other process) without written permission of the publisher, or processed, duplicated or distributed by using electronic systems.

© N.V. Vermeiren N.V. 2013

Contents

| | |
|---|-----------|
| Preface | 2 |
| 1 Productdescription..... | 3 |
| 1.1 Intended Use..... | 3 |
| 1.2 Technical specifications | 4 |
| 1.3 Drawing..... | 5 |
| 1.4 Accessories..... | 5 |
| 1.5 Explanation of symbols..... | 5 |
| 1.6 Safety rules..... | 6 |
| 2 Use | 6 |
| 2.1 Carrying the wheelchair | 6 |
| 2.2 Unfolding the wheelchair..... | 7 |
| 2.3 Mounting or removing of the footrests | 7 |
| 2.4 Operating the brakes..... | 7 |
| 2.5 Mounting or removing of arm supports | 8 |
| 2.6 Transfer in and out the wheelchair..... | 9 |
| 2.7 Correct position in the wheelchair | 9 |
| 2.8 Riding the wheelchair..... | 10 |
| 2.9 Moving on slopes | 10 |
| 2.10 Negotiating steps or curbs | 10 |
| 2.11 Fold up the wheelchair | 12 |
| 2.12 Pushbar..... | 12 |
| 2.13 Transport in the car..... | 12 |
| 3 Installation and adjustment | 13 |
| 3.1 Tools | 13 |
| 3.2 Manner of delivery | 13 |
| 3.3 Anatomical seat | 14 |
| 3.4 Anatomical back..... | 14 |
| 3.5 Adjust the brakes..... | 14 |
| 3.6 Adjusting of the footrests | 15 |
| 4 Maintenance | 15 |

Preface

First of all we want to thank you for putting your trust in us by selecting one of our wheelchairs.

The Vermeiren wheelchairs are the result of many years of research and experience. During the development, special attention was given to the ease of use and the serviceability of the wheelchair.

The expected lifetime of your wheelchair is strongly influenced by the care and maintenance of the wheelchair.

This manual will help you get acquainted with the operation of your wheelchair.

Following the user instructions and the maintenance instructions are an essential part of the warranty.

This manual reflects the latest product developments. Vermeiren has the right to introduce changes without the obligation to adapt or replace previously delivered models.

For any further questions, please consult your specialist dealer.

1 Productdescription

1.1 *Intended Use*

The wheelchair is intended for people with walking difficulties or no walking abilities.

The wheelchair is designed to transport 1 person.

The wheelchair is suited for indoor and outdoor use.

The user can propel the wheelchair by himself or have the wheelchair pushed by an attendant.

The different types of fittings and accessories, and the modular construction allow full use by persons disabled by:

- paralysis
- loss of limbs (leg amputation)
- limb defects or deformations
- stiff or damaged joints
- heart insufficiencies and poor blood circulation
- balance disturbances
- cachexia (decrease in muscle)
- and also for aged persons.

When providing for individual requirements:

- body size and weight (max. 200 kg)
- physical and psychological condition
- residential circumstances
- environment

should be taken into consideration.

Your wheelchair should only be used on surfaces where all four wheels are touching the ground and where there is sufficient contact to propel the wheels equally.

You should practice for use on uneven surfaces (cobblestones, etc.), slopes, curves and to get past obstacles (curbs, etc.).

The wheelchair should not be used as a ladder, nor is it a transport for heavy or hot objects.

When used on mats, carpeted floors or loose floor coverings, the floor covering can get damaged.

Use only Vermeiren approved accessories.

The manufacturer is not liable for damage caused by the lack of or improper service or as a result of not following instructions from this manual.

Compliance with the user and maintenance instructions are an essential part of the guarantee conditions.

Visually impaired people can contact the dealer for the instructions for use.

1.2 Technical specifications

Technical terms below are valid for the wheelchair in standard settings. If other footrests / arm supports or other accessories are used, the tabulated values will change.

Supports or other accessories are added, the tabulated values will change!

| | | | | | |
|---|--|---------|-----------------|-----------|---|
| Make | Vermeiren | | | |  |
| Address | Vermeirenplein 1/15, B-2920 Kalmthout | | | | |
| Type | Manual wheelchair | | | | |
| Model | Eclips XXL | | | | |
| Maximum occupant mass | 200 kg | | | | |
| Description | Dimensions | | | | |
| Effective seat width | 600 mm | 650 mm | 700 mm | 750 mm | |
| Overall width (depends on the seat width) | 850 mm | 900 mm | 950 mm | 1000 mm | |
| Effective seat depth | 530 mm | 540 mm | 550 mm | 560 mm | |
| Description | Dimensions Min. | | Dimensions Max. | | |
| Overall length with footrests | 1140 mm | | | | |
| Folded length without footrests | 865 mm | | | | |
| Folded width | 375 mm | | | | |
| Total height | 1030 mm | | | | |
| Folded height (without backrest) | 945 mm | | | | |
| Total mass | ± 38,5 kg | ± 39 kg | ± 40 kg | ± 40,5 kg | |
| Mass of heaviest part | ± 20,25 kg | | | | |
| Masses of parts that can be dismantled or removed | Foot supports: 2,40 kg; Arm supports: 1,95 kg; Back cushion: 4,25 kg - 5 kg; Seat cushion: 6,95 kg - 7,5 kg | | | | |
| Static stability downhill | 7,5° (in standard configuration) | | | | |
| Static stability uphill | 5° (in standard configuration) | | | | |
| Static stability sideways | >16° (in standard configuration) | | | | |
| Obstacle climbing | 60 mm | | | | |
| Seat plane angle | 5° | | | | |
| Seat surface height at front edge | 530 mm | | | | |
| Backrest angle | 5° | | | | |
| Backrest height | 570 mm | | | | |
| Distance between footrest and seat | 415 mm | | 510 mm | | |
| Angle between seat and footrest | 107° | | | | |
| Distance between armrest and seat | 200 mm | | | | |
| Front location of armrest structure | 405 mm | | | | |
| Handrim diameter | 465 mm | | | | |
| Horizontal location of axle (deflection) | 18 mm | | | | |
| Minimum turning radius | 1743 mm | | | | |
| Diameter Krypton PU Rear wheels | 22" | | | | |
| Tyre pressure, rear (driving) wheels (only for air tyres) | Max. 3.5 bar | | | | |
| Diameter Krypton PU steering wheels | 200 mm | | | | |
| Tyre pressure, steering wheels (only for air tyres) | Max. 2.5 bar | | | | |
| Storage and use temperature | + 5 °C | | + 41 °C | | |
| Storage and use humidity | 30% | | 70% | | |
| We reserve the right to introduce technical changes. Measurement tolerance ± 15 mm / 1,5 kg / | | | | | |

We reserve the right to introduce technical changes. Measurement tolerance ± 15 mm / 1,5 kg / °

Table 1: Technical specifications Eclips XXL

The wheelchair complies to the requirements set up in:

ISO 7176-8: Requirements and test methods for static, impact and fatigue strengths.

ISO 7176-16: Resistance to ignition of upholstered parts

1.3 Drawing

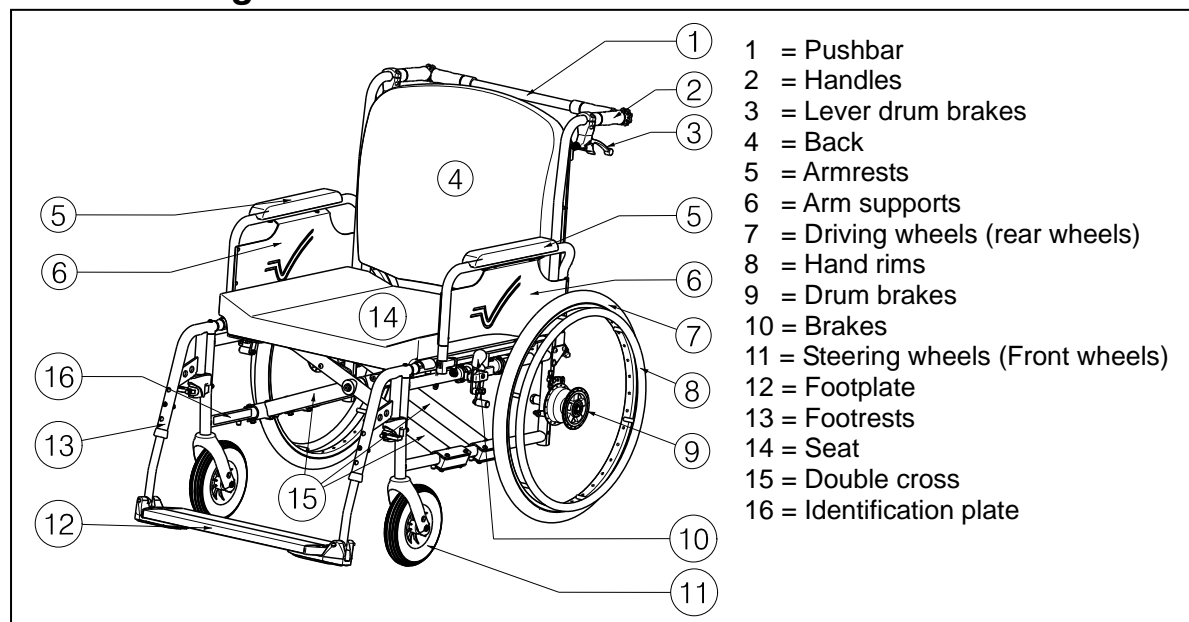

1.4 Accessories

The following accessories are available for the Eclips XXL:

- Anterior pelvic belt (B58) for mounting on the tubes of the back
- Anti-tipping device (B78) for mounting on the bottom frame
- Side supports/pellets (L04) for mounting on the fixed back
- Transit wheelchair (T30)
- Drum brakes (B74)

Contact your specialist dealer about other accessories. He will gladly advise you.

1.5 Explanation of symbols



Maximum mass



Indoor and outdoor use



Maximum Safe Slope



CE conformity



Type designation



Not intended to be used as a seat in a Motor vehicle

1.6 Safety rules

- ⚠ To prevent injury and/or damage to your wheelchair, make sure that no objects and/or body parts are caught in the spokes of the driving wheels.
- ⚠ The parking brakes should be applied before getting into and out of the wheelchair. The parking brakes should be applied when adjusting/mounting the backrest, arm supports, ...
- ⚠ When getting into and out of the wheelchair, do not stand on the footplate. These should be folded up beforehand, or the footrests should be swung completely outwards out of the way.
- ⚠ Investigate the effects of shifting the centre of gravity on the behavior of the wheelchair, for example on up or down gradients, on laterally sloping ground, or when overcoming obstacles. Obtain support from an attendant.
- ⚠ If you want to pick up something (lying in front of, on the side, or to the rear of the wheelchair), you should not lean too far out to avoid tipping over.
- ⚠ When moving through doors, arches, etc. ensure that there is enough room at the sides so that you do not get your hands or arms caught or crushed and that there is no damage to the wheelchair.
- ⚠ Only use your wheelchair according to regulations. For example, avoid uncontrolled rolling against obstacles (steps, curbs, doorframes, etc) or dropping down from ledges. The manufacturer cannot assume liability for damage caused by overloading, collision or other improper use.
- ⚠ Stairs may only be negotiated when aided by another person. If furnishings like drive-on, ramps or lifts are available, use them.
- ⚠ When moving on the public highway, you are subject to the rules of the road.
- ⚠ When driving your wheelchair, you should not be under the influence of alcohol or medicine as in the case of driving other vehicles. This also applies to indoor driving.
- ⚠ When travelling outdoors, adapt your driving to weather and traffic conditions.
- ⚠ When transporting the wheelchair, never pick it up by grasping movable parts (arm supports, footrests, etc.)
- ⚠ To be better visible when driving in the dark, wear the brightest possible clothing or clothes with reflectors, and check that the reflectors mounted on the sides and rear of the wheelchair are clearly visible.
- ⚠ Be careful when using possible causes of fire such as cigarettes since they may set the seat and back covers alight.
- ⚠ Never exceed the maximum load of 200 kg.

2 Use

This chapter describes the everyday use. **These instructions are for the user and the specialist dealer.**

The wheelchair is delivered fully assembled by your specialist dealer. The instructions intended for the specialist dealer on how to set up the wheelchair are given in § 3.

2.1 Carrying the wheelchair

The best way to carry the wheelchair is to make use of the wheels and roll the wheelchair.

If this is not possible (e.g. when the rear wheels are taken off for transportation in a car), firmly grasp the frame on the front and the grips. Do not use the foot or arm rests or the wheels to grasp the wheelchair.

2.2 Unfolding the wheelchair

⚠ CAUTION: Risk of clamping – Keep fingers away from moving parts of the wheelchair.

1. Position yourself behind the wheelchair.
2. Use the hand-grips to open the wheelchair as much as possible.
3. Position yourself at the front of the wheelchair.
4. Push both seating tubes down till they are fixed in their position.
5. Place the seat and backrest cushion in the wheelchair.
6. When the pushbar is available, mount the push pole to the wheelchair.

2.3 Mounting or removing of the footrests

⚠ CAUTION: Risk of injury – Check that the footrests are firmly mounted before using your wheelchair.

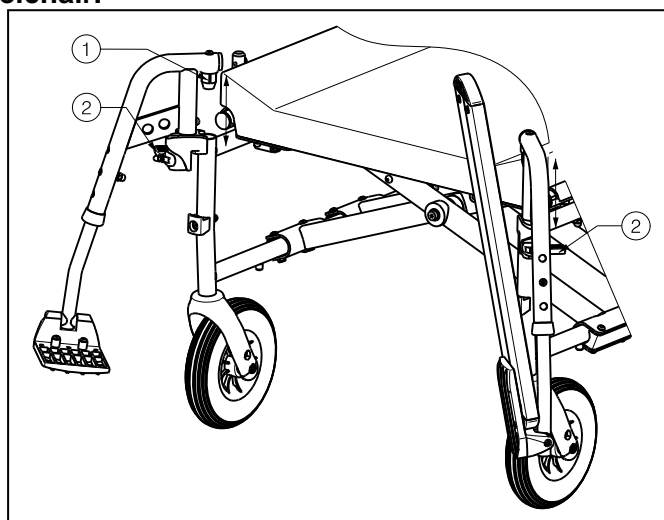

The mounting of the footrests is done as follows:

1. Hold the footrest sideways at the outside of the wheelchair frame and mount the tube hood ① into the frame.
2. Swing the footrest inwards till it clicks in position.
3. Turn the footplate downwards.
4. Check that the footplate is firmly mounted.

To take off the footrests:

1. Grasp the footplate.
2. Turn the footplate upwards.
3. Pull handle ②.
4. Swing the footrest to the outside of the wheelchair till it comes loose from the guidance.
5. Pull the footrest from tube hood ①.

2.4 Operating the brakes

⚠ WARNING: The brakes are not used to slow down the wheelchair during movements – Use the brake only to prevent the wheelchair from unintended movements.

⚠ WARNING: Good operation of the brakes is influenced by wear and contamination of the tires (water, oil, mud, ...) – Check the condition of the tires before each use.

⚠ WARNING: The brakes are adjustable and can wear – Check the operation of the brakes before each use.

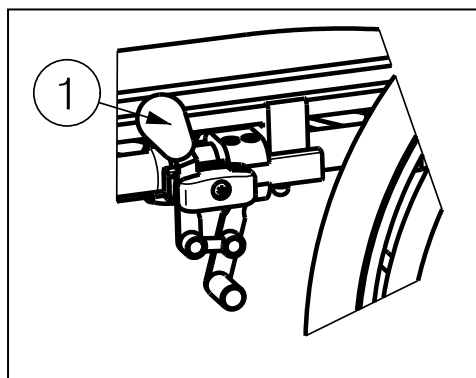

To apply the brakes:

1. Push the brake handles ① forward till you feel a distinctive click.

⚠ CAUTION: Risk of unintended movement – Make sure the wheelchair is on a flat horizontal surface before releasing the brakes. Never release both brakes simultaneously.

To release the brakes:

1. Release one brake by pulling the handle ① backwards.
2. Hold the hand-rim of the released wheel with your hand.
3. Release the second brake by pulling the handle backwards.

2.5 Mounting or removing of arm supports

⚠ CAUTION: Risk of clamping – Keep fingers, buckles and clothes away from the bottom side of the arm support.

⚠ CAUTION: Risk of injury – Check that the arm supports are firmly mounted before using your wheelchair.

The arm supports of the wheelchair can be mounted by following instructions.

1. Mount the rear tube of the arm supports in tube hood ①. (Fig A)
2. Make sure the arm support is mounted very well.
3. Fold the arm support forward.
4. Pull the lever ② on tube hood ③ upwards. (Fig B)
5. Click the front tube of the arm support ④ in tube hood ③. (Fig B)

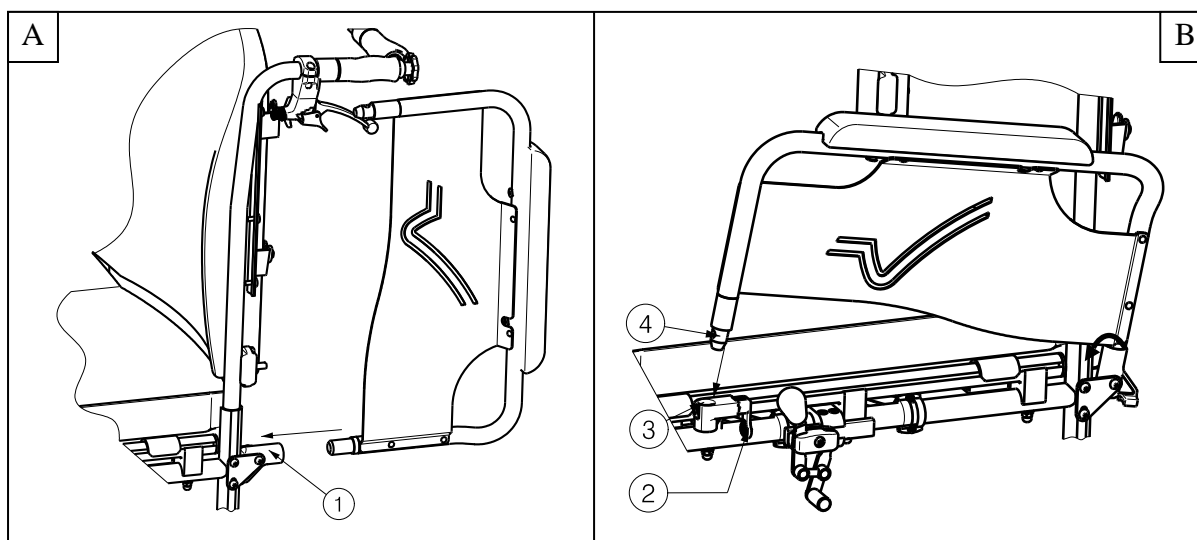

To open and remove the arm support:

1. Pull lever ② and pull the front of the arm support ① upwards. (Fig C)
2. Fold the arm support backwards.
3. To remove the arm support, pull the rear of the arm support from tube hood ③. (Fig D)

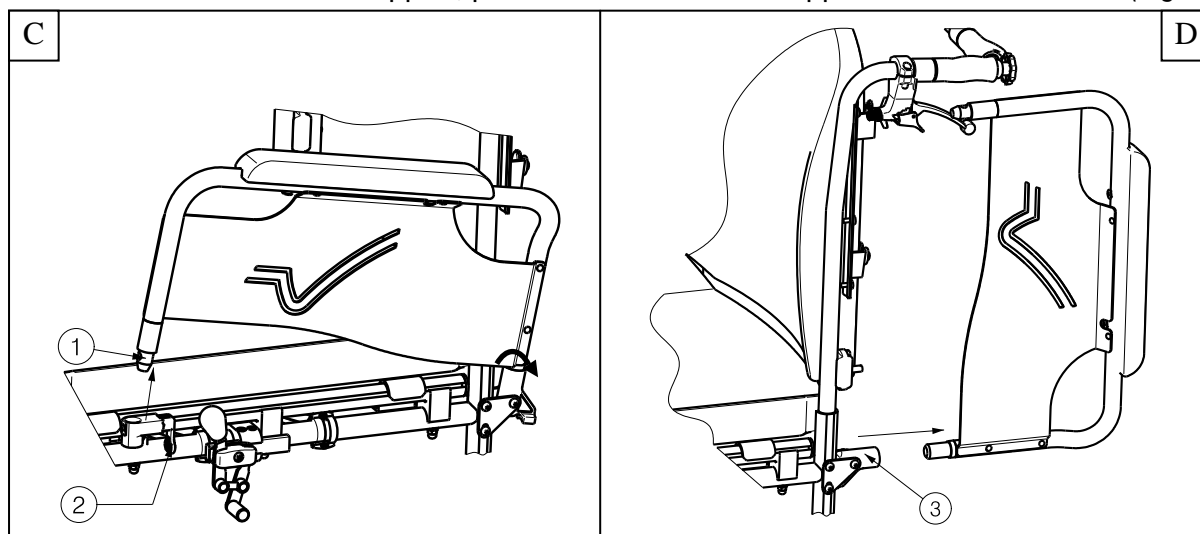

2.6 Transfer in and out the wheelchair

⚠ CAUTION: In case you cannot perform the transfer in a safe manner, ask someone to assist you.

⚠ CAUTION: Risk of tipping over of the wheelchair – Do not stand on the footplate.



1. Position the wheelchair as close as possible to the chair, couch or bed to/from you wish to transfer.
2. Check both brakes from the wheelchair are in the on position.
3. Fold the footplate upwards to prevent standing on them or remove the footrest on that side (see § 2.3)
4. If the transfer is on the side of the wheelchair, fold the arm support on that side upwards. (see § 2.5)
5. Transfer to/from the wheelchair.

2.7 Correct position in the wheelchair

Some recommendations for a comfortable use of the wheelchair:

- Position your backside as close as possible to the back rest.
- Make sure your upper legs are horizontal – If needed adjust the length of the footrests. (see § 3.6.1)

2.8 Riding the wheelchair

- ⚠ **WARNING:** Risk of clamping – Prevent your fingers from being caught by the wheels spokes.
 - ⚠ **WARNING:** Risk of clamping – Be careful passing through restricted passages (e.g. doors).
 - ⚠ **WARNING:** Risk of burns – Be careful when driving in hot or cold environments (sunshine, extreme cold, saunas, etc.) for a sufficient amount of time and when touching - Surfaces can assume the environment temperatures.
1. Release the brakes.
 2. Take both hand rims at their highest position.
 3. Lean forward and push the hand rims forward until straight arms.
 4. Swing your arms loosely back to the hand rims topside and repeat the movement.

2.9 Moving on slopes

- ⚠ **WARNING:** Control your speed – Moving on slopes as slow as possible.
- ⚠ **WARNING:** Consider the capacities of your attendant – If your attendant does not have enough force to control the wheelchair, put on the brakes.
- ⚠ **WARNING:** Risk of tipping over – Lean forward to move your centre of gravity forward. To improve a better stability.



1. If available on the wheelchair, wear the safety belt.
2. Do not attempt moving on too high slopes. The maximum slope angles (upwards and downwards) are mentioned in table 1.
3. Ask an attendant to help you moving on the slope.
4. Lean forward to move your centre of gravity forward.

2.10 Negotiating steps or curbs

2.10.1 Getting down steps or curbs

Riding down low curbs can be done moving forwards. Make sure that the foot rests do not touch the ground.



A practiced user can negotiate small steps or curbs by himself:

- ⚠ **WARNING:** Risk of tipping over – If you do not have enough experience with your wheelchair, ask assistance of an attendant.
1. Bring balance on the rear wheels to reduce the pressure on the front wheels.
 2. Negotiate the curbs.

Higher curbs can be taken forward with an attendant:

1. Ask the attendant to tip the wheelchair slightly backwards.
2. Get past the curbs while moving on the rear wheels.
3. Put the wheelchair back on the four wheels.



An experienced user can negotiate higher curbs by himself. This is best done backwards.

1. Turn the wheelchair to have the rear wheels facing the curbs.
2. Lean forward to move your centre of gravity forward.
3. Move the wheelchair close to the curbs.
4. Use the hand rim to roll-off wheelchair from the curbs in a controlled manner.

2.10.2 Moving up steps or curbs

Moving up steps or curbs with attendant as follows:



1. Prevent the foot rests from touching the curbs.
2. Ask the attendant to tip the wheelchair backwards, just enough to move the front wheels over the curbs.
3. Lean backwards to move your centre of gravity above the rear wheels.
4. Place the front wheels on the curbs.
5. Roll rear wheels of the wheelchair over the curbs.

Higher curbs are negotiated backwards:

1. Turn the wheelchair to have the rear wheels facing the curbs.
2. Lean backwards and move your centre of gravity above the rear wheels.
3. Ask the attendant to pull the wheelchair on the curbs.
4. Take back the normal position in the wheelchair.

An experienced user can negotiate curbs by himself:

⚠ WARNING: Risk of tipping over – If you have not enough experience to control the wheelchair, get help from an attendant.



1. Drive until the curbs.
2. Ensure that the footrest do not touch the curbs.
3. Lean backwards so you are balancing on the rear wheels.



4. Role the front wheels balancing over the curbs.
5. Bend forward for more stability.
6. Role the rear wheels over the curbs.

2.10.3 Taking of stairs

Taking of stairs while you staying in the wheelchair shall be according following rules:

⚠ WARNING: Risk of tipping over – Taking of stairs shall always with 2 attendants.

1. Remove the footrests.
2. One attendant tip the wheelchair slightly backwards.
3. The second attendant take the front of the frame.
4. Stay calm, avoid sudden movements and keep your arms inside the wheelchair.
5. Take the steps on the rear wheels of the wheelchair.
6. Mounting the footrests back after taking the stair.

2.11 Fold up the wheelchair

⚠ CAUTION: Chance of pinching – Do not place fingers between the components of the wheelchair.

1. When the pushbar is available, remove the pushbar.
2. Remove the footrests (see § 2.3).
3. Remove the seat and backrest cushions.
4. Take the tubes of the seat and move these upwards.
5. Push on the hand-grips to fold up the wheelchair further.

2.12 Pushbar

⚠ WARNING: Risk of injury - Make sure that all screws are properly tightened with the appropriate tool.

⚠ WARNING: Risk of injury - When equipped with the pushbar, the pushbar shall always be mounted (→ to increase the stability of the back).

The pushbar will be delivered for some seat widths. The pushbar increase the stability of the back and offer you the possibility of pushing the wheelchair by an attendant. To do this, use the pre-mounted handles.

As there are different pushbar for different seat widths, take care that no tension between the pushing handles of the back tubes is created.

The mounting of the pushbar is done as follows:

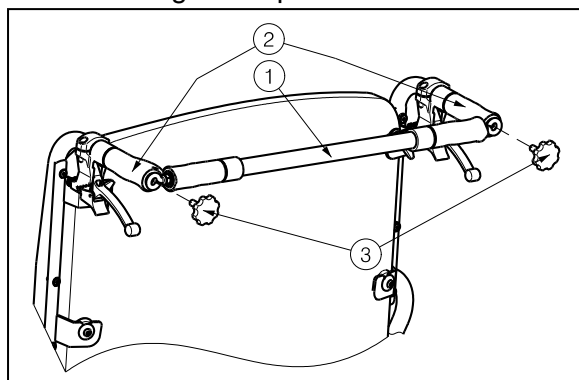

1. Secure the pushbar ① by fastening the left side to the end of handle ② with the Philips screw ③ in the applicable sunk threads.
2. Screw gently the Philips screw ③ into the thread of the handle ②.
3. Swing the pushbar to the right.
4. Screw gently the Philips screw ③ into the thread of the right handle ②.

To take off the push pole:

1. Loosen the Philips screw ③ on the right and/or left hand-grip.
2. Remove the pushbar from the right and/or left hand-grip.

2.13 Transport in the car

⚠ DANGER: Risk of injury – The wheelchair is not suited for use as a seat in a motor vehicle.

⚠ WARNING: Risk of injury – See that the wheelchair is attached properly. So you can avoid injury from the passengers during collision or sudden braking.

⚠ WARNING: Risk of injury – Use for attaching the wheelchair and passenger **NEVER** the same seatbelt.

Never use your wheelchair as a seat in an automobile or other vehicle. The wheelchair shall be marked with following symbol.



To transport the wheelchair in the car use following steps:

1. Remove footrests and accessories.
2. Store footrests and accessories safely.
3. If possible, fold the wheelchair and remove the wheels.
4. Place the wheelchair in the luggage place.
5. If the wheelchair and the passenger compartment is NOT separated, attach the frame of the wheelchair securely to the vehicle. You can use the available safety belts in the vehicle.

3 Installation and adjustment

The instructions in this chapter are for the specialist dealer.

The Vermeiren Lightweight wheelchairs Eclips XXL has been designed entirely for your comfort. This wheelchair can be adjusted to individual requirements as explained below.

To find a service facility or specialist dealer near you, contact the nearest Vermeiren facility. A list of Vermeiren facilities can be found on the last page.

⚠ WARNING: Risk of unsafe settings - Use only the settings described in this manual.

⚠ WARNING: Variation of allowed adjustments can still change the stability of your wheelchair (tilt back or sideways).

3.1 Tools

To set up the wheelchair the following tools are needed.

- Wrench set n° 10 to n° 19
- Allen key set n° 4 to n° 5
- Screwdriver Phillips head

3.2 Manner of delivery

The Vermeiren Eclips XXL shall be delivered with:

- 1 frame with arm supports, rear and front wheels
- 1 pair footrests
- Anatomical seat (fixed)
- Anatomical back (fixed)
- Tools
- Manual
- Accessories

When you receive the wheelchair, please check that the product supplied is complete and fully functional. Warranty claims are only valid if the manufacturer (supplier) is notified in writing within a period of two weeks. In the case of any defect that is not immediately evident, warranty claims are only valid if the manufacturer (supplier) is notified in writing within two weeks after it is detected.

3.3 Anatomical seat

- ⚠ **WARNING:** Risk of injury – Check that the seat is firmly secured before use. Check that the screws are not damaged.
- ⚠ **WARNING:** Risk of injury – Avoid getting your fingers caught during the assembly process (between seat and cross-hinge).

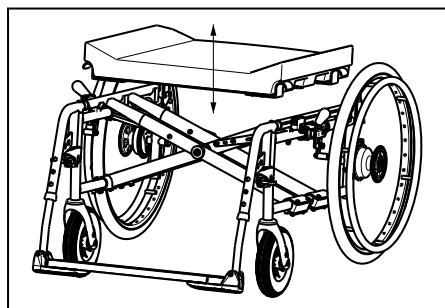

Your wheelchair has an anatomical padded seat, place it on the tubular cross-hinge so that the seat's supports engage equally with the cross-hinge. In the wooden base you will find slots that are placed in the hinge's cross-pieces. To fold up the wheelchair, remove the seat by pulling it upwards.

3.4 Anatomical back

- ⚠ **WARNING:** Risk of injury – Check that the backrest is firmly mounted into the four brackets before using your wheelchair.
- ⚠ **WARNING:** Risk of injury – Avoid getting your fingers, clothes caught during the assembly process.

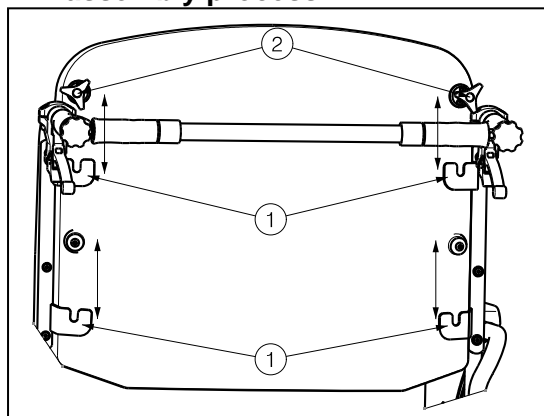

The backrest of the wheelchair can be mounted by following instructions.

1. Mount the backrest into the four brackets ①.
2. Turn on the upper star buttons ② to lock the star buttons by hand.
3. Check that the backrest is firmly fixated.

To remove the backrest of the wheelchair:

1. Loosen the upper star buttons ②.
2. Pull the backrest upwards out the four brackets ①.

3.5 Adjust the brakes

- ⚠ **WARNING:** Risk of injury – Brakes may only be adjusted by your specialist dealer.

Adjust the brakes according following rules:

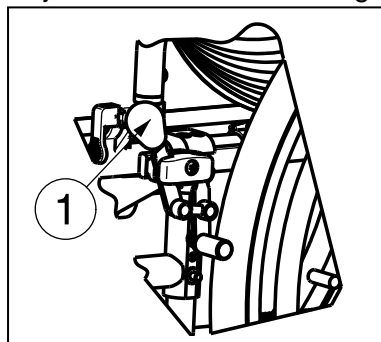

1. Disconnect the brakes by pulling lever ① backwards.

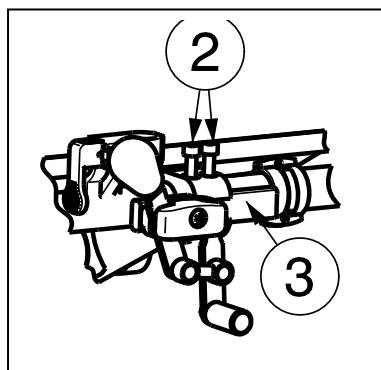

2. Loosen the bolts ② so the brake mechanism can slide over the guide ③.
3. Pull the brake mechanism over the guide ③ to the desired position.
4. Retighten the bolts ②.
5. Check working of the brakes.
6. If necessary repeat the above steps until the brakes are adjusted well.

3.6 Adjusting of the footrests

3.6.1 Length of the footrests

⚠ CAUTION: Risk of damage – Avoid that the footrests make any contact with the ground. Keep a minimum distance from 60 mm above the ground.

Adjust the length of the footrests as follow (in eight different positions): (Fig A)

1. Remove the screw ②.
2. Adjust the length of the footrest to a comfortable length.
3. Tighten the screw ② properly.

3.6.2 Depth of the footplate

Adjust the depth of the footplate as follow (in three different positions):

1. Remove the screws ①. (Fig A)
2. Adjust the depth of the footrest to a comfortable position (Fig B).
Position 1: hole 1 and 3
Position 2: hole 2 and 4
Position 3: hole 3 and 5
3. Tighten the screws properly ①. (Fig A)

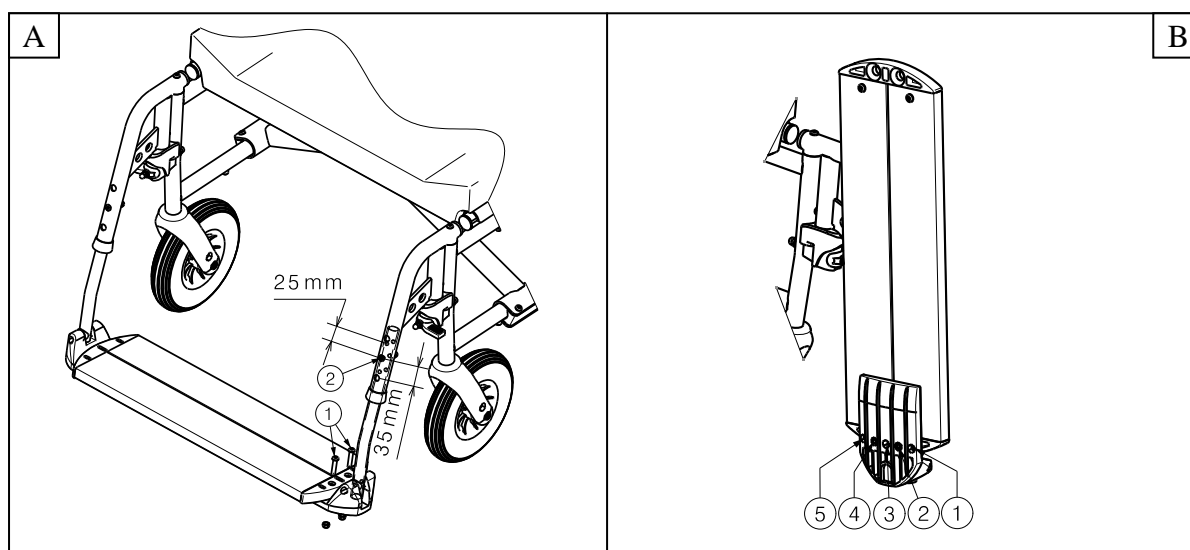

4 Maintenance

For the maintenance manual of the wheelchairs refer to the Vermeiren website:
www.vermeiren.be.



SERVICE

The manual wheelchair was serviced:

Dealer's stamp:

Date:

Dealer's stamp:

Date:

Dealer's stamp:

Date:

Dealer's stamp:

Date:

Dealer's stamp:

Date:

Dealer's stamp:

Date:

Dealer's stamp:

Date:

Dealer's stamp:

Date:

Dealer's stamp:

Date:

Dealer's stamp:

Date:

- For service checklists and additional technical information, please see our specialist dealers nearest to you. More information on our website at: www.vermeiren.com.

Belgium

N.V. Vermeiren N.V.

Vermeirenplein 1 / 15
B-2920 Kalmthout
Tel: +32(0)3 620 20 20
Fax: +32(0)3 666 48 94
website: www.vermeiren.be
e-mail: info@vermeiren.be

Germany

Vermeiren Deutschland GmbH

Wahlerstraße 12 a
D-40472 Düsseldorf
Tel: +49(0)211 94 27 90
Fax: +49(0)211 65 36 00
website: www.vermeiren.de
e-mail: info@vermeiren.de

France

Vermeiren France S.A.

Z. I., 5, Rue d'Ennevelin
F-59710 Avelin
Tel: +33(0)3 28 55 07 98
Fax: +33(0)3 20 90 28 89
website: www.vermeiren.fr
e-mail: info@vermeiren.fr

Austria

L. Vermeiren Ges. mbH

Winetzhammerstraße 10
A-4030 Linz
Tel: +43(0)732 37 13 66
Fax: +43(0)732 37 13 69
website: www.vermeiren.at
e-mail: info@vermeiren.at

Italy

Reatime S.R.L.

Viale delle Industrie 5
I-20020 Arese MI
Tel: +39 02 99 77 07
Fax: +39 02 93 58 56 17
website: www.reatime.it
e-mail: info@reatime.it

Switzerland

Vermeiren Suisse S.A.

Hühnerhubelstraße 59
CH-3123 Belp
Tel: +41(0)31 818 40 95
Fax: +41(0)31 818 40 98
website: www.vermeiren.ch
e-mail: info@vermeiren.ch

Poland

Vermeiren Polska Sp. z o.o

ul. Łączna 1
PL-55-100 Trzebnica
Tel: +48(0)71 387 42 00
Fax: +48(0)71 387 05 74
website: www.vermeiren.pl
e-mail: info@vermeiren.pl

Spain

Vermeiren Iberica, S.L.

Trens Petits, 6. - Pol. Ind. Mas Xirgu.
17005 Girona
Tel: +34 902 48 72 72
Fax: +34 972 40 50 54
website: www.vermeiren.es
e-mail: info@vermeiren.es

Czech Republic

Vermeiren ČR S.R.O.

Sezemická 2757/2 - VGP Park
193 00 Praha 9 - Horní Počernice
Tel: +420 731 653 639
Fax: +420 596 121 976
website: www.vermeiren.cz
e-mail: info@vermeiren.cz