

EasyUP support arms

INSTALLATION AND USER MANUAL

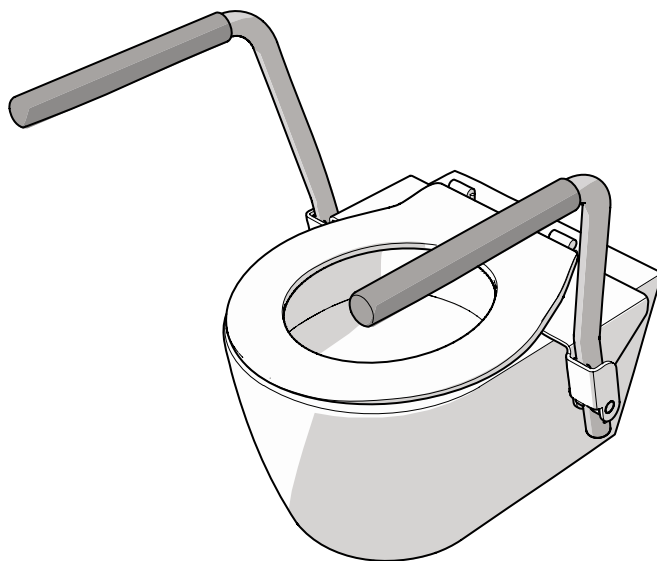

ABOUT THIS MANUAL

Welcome to the user and installation manual for the EasyUP support arms. This product is designed to help individuals with reduced mobility and/or muscle strength to use the toilet safely and independently. It also eases the physical strain on caregivers who assist with toileting.

Language

The original manual is written in UK English. All other language versions are translations of the original manual.

Intended readers

This manual is intended for:

- The user of the product
- The worker that installs the product

Symbols used

This manual contains safety instructions that may result in injury when ignored. Each safety warning is indicated with a signal word. The signal word corresponds with the level of risk of the described hazardous situation:

Safety symbol	Level of risk	Result if not avoided
 CAUTION	Low	Could result in moderate or minor injury or damage to the product.

Safety warnings given at the start of a section apply to the entire section.

Other symbols used

This manual contains symbols that indicate useful information that complements the instructional text and illustrations.

Symbol	Meaning
 NOTICE	Messages that are not hazard-related are indicated with the signal word NOTICE. These messages do not have a safety alert symbol.

TABLE OF CONTENTS

1. Product	4
1.1. Intended use	4
1.2. Reasonably foreseeable unintended use	4
1.3. General specifications	4
2. Description	5
2.1. Main parts	5
3. Safety	6
3.1. Safety features	6
3.2. Safety symbols and labels on the product	6
3.3. Safety warnings and regulations	6
4. Installation	7
4.1. Tools needed	7
4.2. Remove packaging	7
4.3. Contents of the package	7
4.4. Preparation	8
4.5. Mounting	9
4.6. Adjusting	10
5. Use	12
6. Maintenance	13
6.1. Spare parts	13
7. Warranty	13
8. Disposal	13

1. PRODUCT

1.1. Intended use

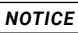
The essential performance of the EasyUP support arms is to:

- Assist individuals with reduced mobility in using the toilet. The product helps to support the user on the toilet.
- Assist caregivers who help individuals with reduced mobility to make use of the toilet.

The essential performance of the support arms must be what it is intended to be and what the end user can expect. If the intended purpose of the essential performance is lost or deteriorates, the product is no longer suitable for the user.

1.2. Reasonably foreseeable unintended use

The following is considered foreseeable misuse:

- Use of the product that deviates from the intended use as described in the previous section.
- Failure to comply with the instructions in this manual.
- Unauthorised removal or modification of parts or safety components of the product.
- Use of spare parts or accessories that have not been approved by the manufacturer.

1.3. General specifications

The most important specifications can be found on the type plate. The type plate can be found on the right hand side at the back of the support arm.

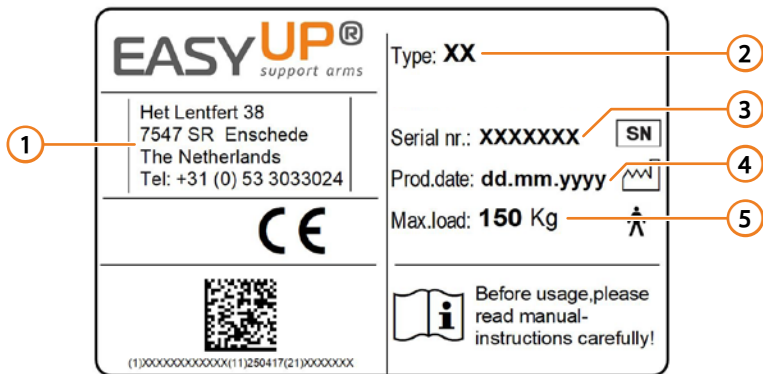

Example of a type plate

- | | |
|--------------------------------|------------------------|
| ❶ Contact details manufacturer | ❷ Production date |
| ❷ Type code | ❸ Maximum nominal load |
| ❸ Serial number | |

The table below is a full overview of all the technical specifications:

Specification	Value
Name of the product	EasyUP support arms
Length, width and height	60 x 30 x 50 cm
Weight	4.5 kg
Operating and storage temperature	-10 – 60 °C
Operating and storage humidity	20 - 70%
Warranty	2 years

2. DESCRIPTION

2.1. Main parts

This is an overview of the main parts of the EasyUP support arms:

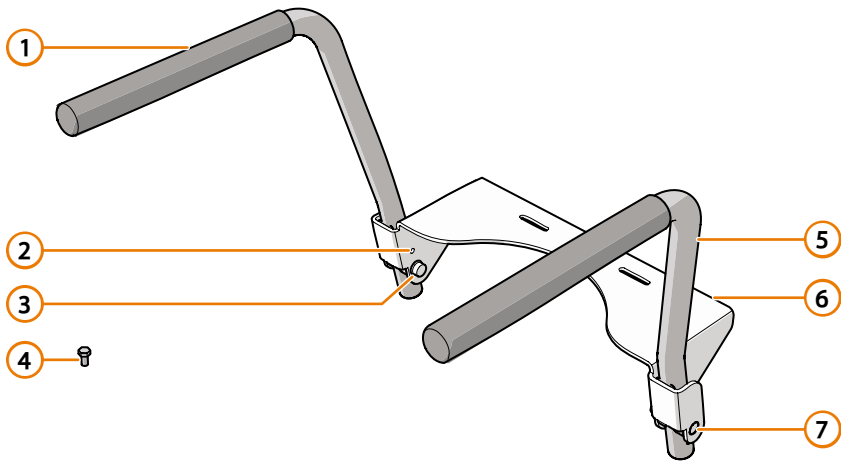

- | | |
|---------------------|----------------------|
| ❶ Right arm support | ❺ Left arm support |
| ❷ Locking bolt hole | ❻ Connecting bracket |
| ❸ Locknut cover cap | ❼ Bolt cover cap |
| ❹ Locking bolt | |

The following add-ons are available:

- Pressalit Dania toilet seat with lid

3. SAFETY

3.1. Safety features

This product has been tested for safety and complies with applicable regulations. The full text of the EU declaration of conformity is available via our website www.aeroletnl.com.

3.2. Safety symbols and labels on the product

This is an overview and explanation of all inflicted safety symbols and labels on the product.



Maximum weight indication of 150 kg / 330 lbs.

3.3. Safety warnings and regulations

3.3.1. General safety warnings

CAUTION

- Risk of serious injury or product damage. Ensure you have fully read and understood the instructions in this document before you install or use the product. Keep the packaging and this document for future reference.
- Risk of serious injury. Only use the product as described in this document.
- Risk of serious injury. Never use the product if a part is damaged or defective. Replace a damaged or defective product or part immediately. Always check the product for damage before use.

3.3.2. Safety warnings for transport

CAUTION

- Risk of product damage. Never drop or handle the product roughly during transport. Handle with care.

3.3.3. Safety warnings for installation

CAUTION

- Product instability hazard. Risk of serious injury due to a loose toilet bowl. A loose toilet bowl can result in unstable armrests. Always anchor the toilet bowl solidly to the floor or wall. Always ensure the product is installed on a stable and level surface. Verify the surface before installation.
- Product instability hazard. Risk of serious injury due to a loose or cracked toilet seat. Ensure the seat is securely fixed. Only use the recommended toilet seat with the correct fixing materials.

3.3.4. Safety warnings for use

CAUTION

- Risk of injury. Always supervise individuals who are unable to use the product independently. Provide assistance as needed.
- Risk of injury. Never exceed the maximum weight capacity. Overloading can cause failing of the product. Check the manufacturer's specifications.
- Child safety hazard. Risk of serious injury or product damage. Never allow children to play with the device. Keep children supervised.
- Risk of falling or product malfunction. Never use the product as a step, ladder, or transfer bridge.
- Risk of product malfunction. Never place heavy objects on the product. Excess weight can cause malfunction. Keep the product clear of additional loads.

- Risk of damage to the armrest padding and loss of armrest grip. Never wear sharp rings when using the product. Remove rings before use.

3.3.5. Safety warnings for maintenance

CAUTION

- Risk of damage to product surfaces. Never use chlorine, hydrochloric acid (lime solvents) or abrasives to clean the product. Use mild soap or diluted bleach instead.

4. INSTALLATION

CAUTION

Product instability hazard. Risk of serious injury due to a loose or cracked toilet seat. Ensure the seat is securely fixed. Only use the recommended toilet seat with the correct fixing materials.

4.1. Tools needed

The following tools are needed to install the EasyUP support arms:

- a 13mm wrench
- a 5mm allen key

4.2. Remove packaging

To remove the packaging material from the product, gently cut along the taped seams with a utility knife, taking care not to press too hard to avoid scratching the surface. Slowly peel away any protective plastic foil or foam cushioning.

4.3. Contents of the package

Check if all parts are present and undamaged. In case of missing or damaged parts, please contact your supplier.

- EasyUP support arms
- 2 locking bolts
- Optional: Pressalit Dania toilet seat and lid

4.4. Preparation

Check that the installation site has the following minimum dimensions for placement of the EasyUP support arms:

Measurement	Measurement requirement
Distance A	125 – 200 mm
Distance B	Max. 390 mm
Distance C	Min. 30 mm
Distance D	Min. 100 mm
Distance E	Min. 50 mm

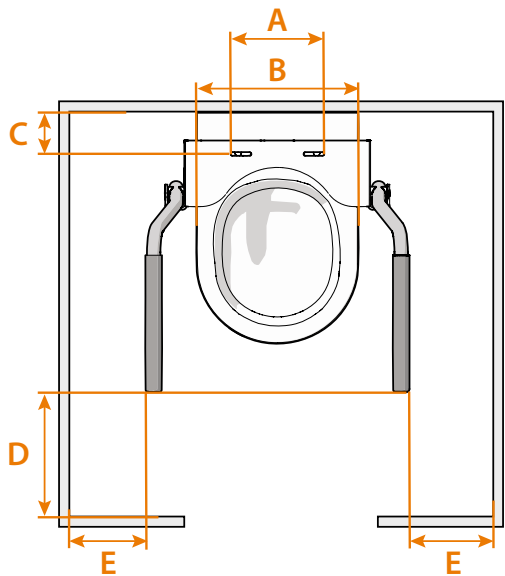

4.4.1. Preparation of toilet bowl

Remove the toilet seat from the toilet bowl. Consult the manual of your specific toilet.

4.5. Mounting

1. Place the EasyUP support arms on the toilet and align the mounting holes of the toilet with the slots on the connecting bracket **6**.
-



2. Install the toilet seat and lid on top of the mounting bracket and toilet bowl. Consult the Pressalit manual or the manual of your specific toilet seat for installation instructions.
-

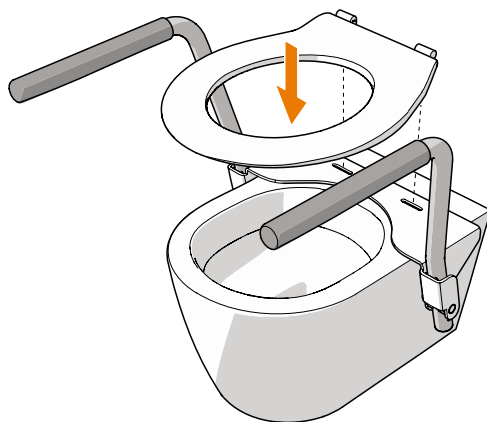

4.6. Adjusting

4.6.1. Armrests height

The left arm support **5** and right arm support **1** can be mounted in three different heights. To change the armrest height:

1. Remove the locknut cover cap **3** and bolt cover cap **7** from both armrests.

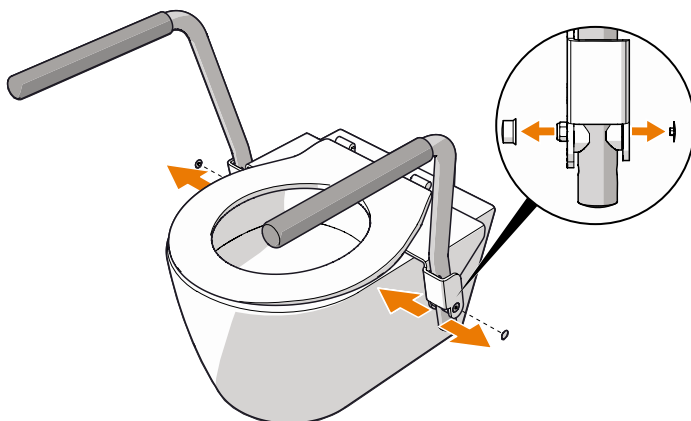

2. Use a 13mm wrench and a 5mm Allen key to remove the bolt and the locknut.

NOTICE

Hold the saddle washers in place to prevent the saddle washers from sliding down.

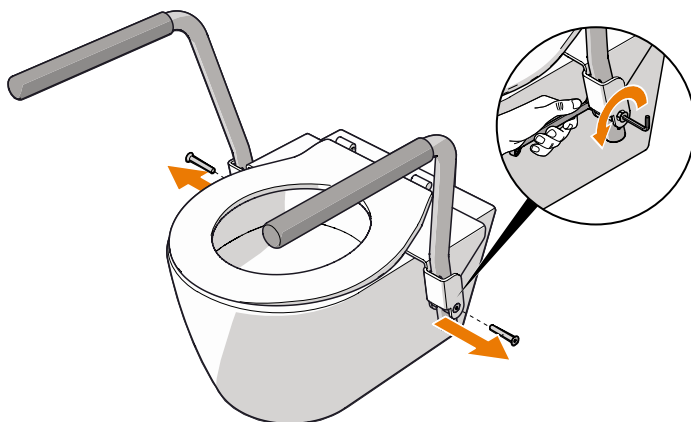

3. Move the armrest to the desired height position.

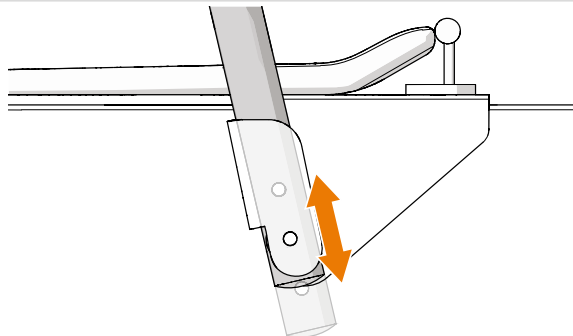

4. Reinsert the bolt through the connecting bracket, the saddle washers and the armrest and install the locknut.
5. Tighten the locknut with the 13 mm wrench while holding the bolt with the 5 mm Allen key.

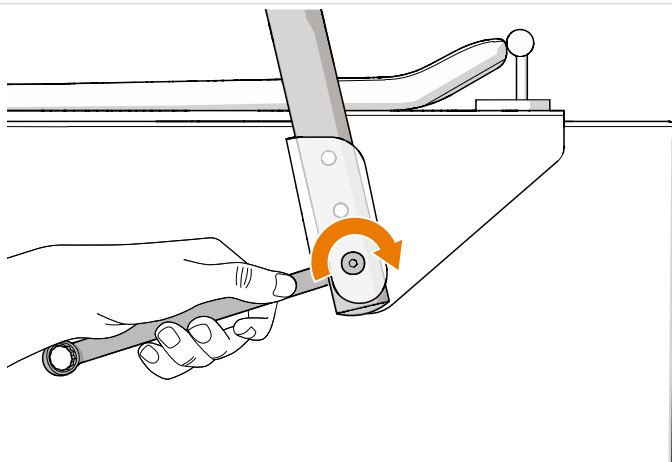

6. Repeat steps 2-5 for the other armrest.

NOTICE

Make sure both armrests are set to the same height.

4.6.2. Lock the armrests

The armrests of the EasyUP can be locked to prevent the armrests from rotating backwards. Always lock the armrests when using a top-mounted bidet system with a water inlet from the side.

To lock the armrests:

1. Place a locking bolt ❹ in a threaded locking bolt hole ❷.
2. Tighten the locking bolt with a 13 mm wrench.
3. Repeat for the other armrest.

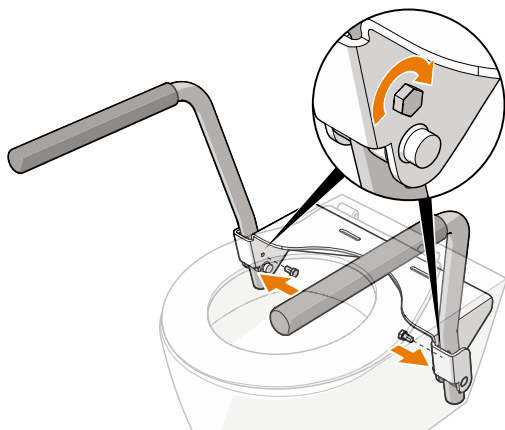

5. USE

When the armrests of the EasyUP are not in use, they can be folded upwards.

1. Push on the front of the armrests to fold the armrests upwards.

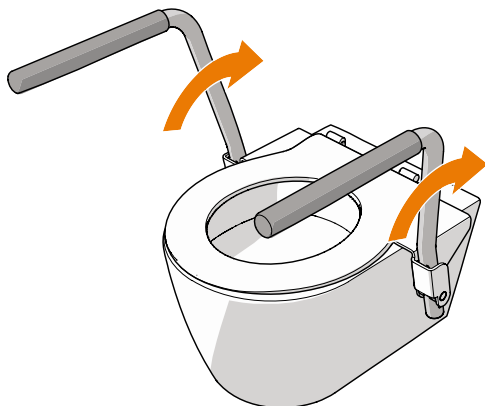

To prevent the armrests from folding upwards, the armrests can be locked. See chapter 4.6.2. for the armrests locking instructions.

6. MAINTENANCE

Clean the product regularly. Use a soft wash cloth with mild soap and warm water solution to wipe down all the surfaces. For heavier soiling, wipe clean with a diluted bleach solution and rinse well before drying. Regularly check if the mounting screws of the toilet seat are tight and that the mounting bracket is firmly clamped to the toilet bowl.

6.1. Spare parts

It is possible to order spare parts on request. Contact your distributor for a parts list.

7. WARRANTY

Aerolet guarantees the EasyUP support arms against material and manufacturing defects for a period of two years from purchase by the end user. The warranty period starts either on the date of delivery, or on the installation date, when the installation has been carried out by a dealer. During this warranty period, a dealer will, at its discretion, repair or replace any defective parts. Parts repaired under warranty should be returned to Aerolet.

The warranty on your EasyUP support arms does not apply to defects resulting from the following:

- Improper or inadequate maintenance by the user.
- Unauthorised adjustments and/or modifications or misuse.
- Use outside the environmental specifications for which the product is intended.

8. DISPOSAL



Separate and dispose the components of the product into the applicable waste streams based on their materials, in accordance with local regulations.



Aerolet

Het Lentfert 38, 7547SR Enschede
www.aeroletnl.com

Original manual
v1.0 - 10/2025